

V 200

Volume

The V200 extraction unit has been designed primarily to extract the fumes generated during hand soldering in the electronics industry. This portable system comes complete with an extraction arm and installation kit that contain everything required to set up an operator with ease. Minimal installation allows this unit to be moved with the work bench when factory layouts need changing due to production challenges. The low noise level and fully comprehensive filtration is ideal for factories with changing production demands.

STANDARD FEATURES:

- Unique flip top flush sealing mounting plate
- Granulated carbon gas filter
- Filter blocked indicator
- 99.997% HEPA filtration
- Advanced Carbon Filter technology

OPTIONAL FEATURE:

- Remote speed control and power switch

PACKAGE INCLUDES:

- V200 Extraction unit
- 1 x Pre filter pad
- 1 x Combined HEPA/ Gas filter
- 1 x Power cable
- 1 x Installation kit and extraction arm



Arm extraction system
for solder applications.



| PART NUMBERS | | | PRE FILTER | COMBINED FILTER |
|--|---------|-------------|----------------|-----------------|
| Model | Voltage | Part Number | PF Part Number | CF Part Number |
| V200 | 230v | E0742A0000 | A1030102 | A1030099 |
| - with installation kit and extraction arm | 115v | E0741A0000 | A1030102 | A1030099 |

| TECHNICAL DATA | | |
|----------------------|--|---|
| | 230V | 115V |
| Dimensions (HxWxD) | 380 x 260 x 260mm | 15 x 10.2 x 10.2" |
| Cabinet Construction | Powder coated mild steel | Powder coated mild steel |
| Airflow / Pressure | 90m ³ /hr / 20mbar | 53cfm / 20mbar |
| Electrical Data | 230v 1ph 50/60Hz Full load current: 0.45 amps / 90w | 115v 60/50Hz Full load current: 0.85 amps / 107w |
| Noise Level | < 54dBA* | < 54dBA* |
| Weight | 7kg | 15lbs |
| Duct Size | 50mm | 2" |
| Duct Run | 3mtrs | 9.8ft |

* At typical operating speed.

| PRE FILTER SPECIFICATIONS | |
|---------------------------|----------------------|
| Filter Media | Glass Fibre |
| Filter Media Construction | Pad |
| Filter Efficiency | F7 (96% @ 2 microns) |

| COMBINED FILTER SPECIFICATIONS | |
|--------------------------------|--|
| HEPA Filter Media | Glass Fibre |
| HEPA Media Construction | Maxi Pleat Construction with Webbing Spacers |
| Gas Filter | Treated Activated Carbon |
| Filter Housing | Zintec Mild Steel |
| Treated Activated Carbon | 1.5kgs |
| Filter Efficiency | 99.997% @ 0.3 microns |

TECHNICAL SPECIFICATION

- 1 Filter Condition Display light
- 2 On / Off Switch
- 3 Hose Inlet Connection - 50mm
- 4 Exhaust Outlet
- 5 Power Cable Inlet
- 6 Lid latches

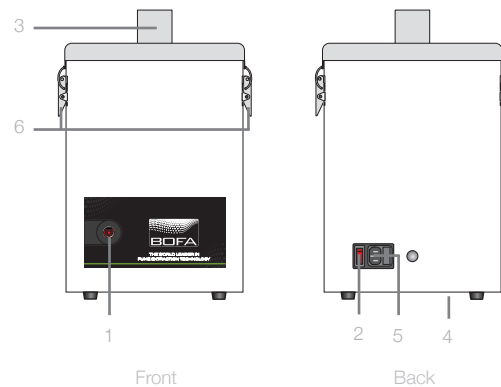

Other hose kits and filters are available. All of the above units are fitted with our standard filter combinations. For specific applications please call us for details. Replacement filters should always be ordered using the part number on the filters inside your extractor to ensure the correct filter is ordered. Datasheet correct at time of print.

SINGLE ARM HIGH VOLUME EXTRACTION UNIT:

Designed to extract fumes for one operator. Ideal for factories with changing demands, resulting in production layout changes.

Comes complete with:

- 50mm ESD Stay Put extraction arm
- Unique flip top flush sealing mounting plate
- Granulated carbon gas filter
- Installation flex and table bracket
- Filter blocked Indicator
- 99.997% HEPA filtration



AIRFLOW THROUGH FILTERS

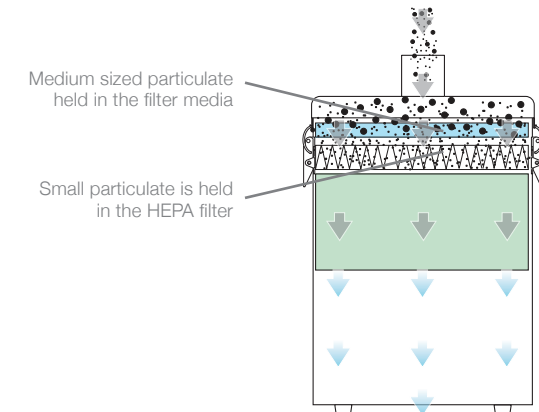
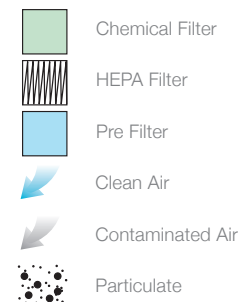

Date:26/3/15 V:2.4



BOFA INTERNATIONAL LTD

Tel: +44 (0) 1202 699 444 Fax: +44 (0) 1202 699 446 Email: sales@bofa.co.uk Web: www.bofa.co.uk

BOFA AMERICAS, INC

Tel: (618) 205 5007 Fax: (866) 707 2632 Email: sales@bofaamericas.com Web: www.bofaamericas.com



British Quality

